



2023/24 PRODUCT GUIDE



TABLE OF CONTENTS

Our Warranty Promise	4-5
----------------------	------------

BACK BAR BOTTLE COOLERS

Hinged Door Bottle Coolers	8-9
Sliding Door Bottle Coolers	10-11

STORAGE REFRIGERATION EQUIPMENT

Under Counter Refrigeration	14-15
Single Door Gastronorm Refrigeration	16-17
Double Door Gastronorm Refrigeration	18-19
Compact Storage Counters	20-21
Compact Prep Counters	22-23
Compact Saladettes	24-25





OUR WARRANTY PROMISE

At Pentland we hope that you never have an issue with any piece of refrigeration or catering equipment you purchase from us, however we know that its not always that simple and a long standing warranty is a key part of a customers decision making process.

That's why in 2023 we are offering higher levels of warranty cover than ever before. We have increased the KoldBox **standard warranty to 2 years** across the entire range to re-enforce the confidence we have in this budget beating brand.

As always you will be able to choose at purchase as to whether you want full parts & labour warranty or parts only warranty, please note as standard our pricing structure offers full parts & labour warranty.



BACK BAR BOTTLE COOLERS

Low cost appliances shouldn't come at the price of quality and that's why our range of budget bottle coolers are not only bottom line friendly but built with the same great materials and processes you'd expect from top bottle cooling brands.

With our back to basics mindset when it comes to the depth of our product range you won't be overwhelmed by 100s of customisable options and instead make the simple choice of the number and type of doors you require!

Now available at a **NEW** discounted price and with **2 years warranty** as standard you'll struggle to justify any other choice.



KBC1

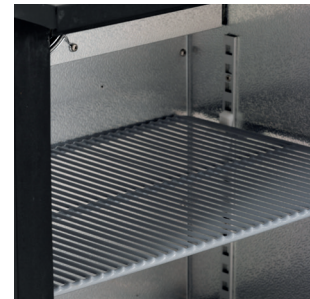

STANDARD BLACK LAMINATED HINGED DOOR BOTTLE COOLER

Description

If you're looking for a straight to the point no thrills bottle cooler then the KBC range is the perfect option for a budget beating bargain! With a clean black exterior and stippled aluminium interior the unit fits seamlessly into any back bar, even while using its integrated LED lighting!

Coming as standard with 2 shelves per self closing double glazed door this unit is an all-round perfect choice for the budget minded buyer!



Features

- Black laminated exterior
- Stippled aluminium interior
- Self closing door(s)
- 2 Adjustable shelves supplied as standard
- Door lock fitted per door
- Internal LED illumination with on/off switch
- Adjustable feet
- Replaceable door gasket



KBC1

DOORS	1
GROSS CAPACITY (BOTTLES)	138L (135)
SHELVES SUPPLIED	2
REFRIGERANT	R600a
TEMPERATURE RANGE	+4°C / +10°C
DIMENSIONS (mm)	H900 x W600 x D520
ENERGY RATING	F
POWER USAGE	150W
KWH/ANNUM	858
POWER	13amp
WEIGHT (kg)	47

RRP £554

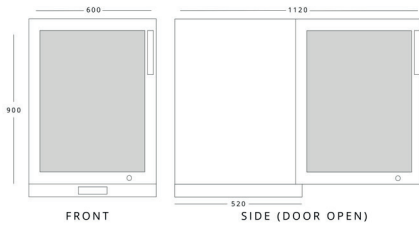

KOLDBOX KBC1
H 900mm W 600mm D 520mm



KBC2

DOORS	2
GROSS CAPACITY (BOTTLES)	218L (202)
SHELVES SUPPLIED	4
REFRIGERANT	R600a
TEMPERATURE RANGE	+4°C / +10°C
DIMENSIONS (mm)	H900 x W900 x D520
ENERGY RATING	F
POWER USAGE	210W
KWH/ANNUM	990
POWER	13amp
WEIGHT (kg)	73

RRP £670

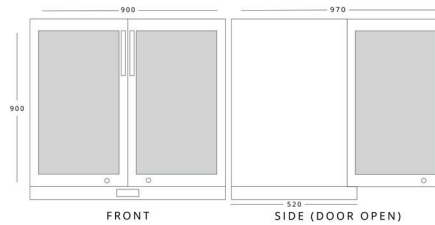

KOLDBOX KBC2
H 900mm W 900mm D 520mm



KBC3

DOORS	3
GROSS CAPACITY (BOTTLES)	338L (338)
SHELVES SUPPLIED	6
REFRIGERANT	R600a
TEMPERATURE RANGE	+4°C / +10°C
DIMENSIONS (mm)	H900 x W1350 x D520
ENERGY RATING	F
POWER USAGE	270W
KWH/ANNUM	1225
POWER	13amp
WEIGHT (kg)	89

RRP £907

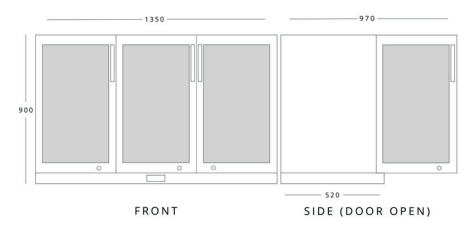

KOLDBOX KBC3
H 900mm W 1350mm D 520mm

KBC2SL

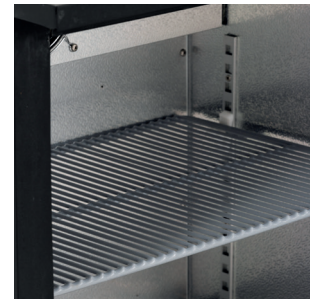

STANDARD BLACK LAMINATED SLIDING DOOR BOTTLE COOLER

Description

If you're looking for a straight to the point no thrills bottle cooler then the KBC range is the perfect option for a budget beating bargain! With a clean black exterior and stippled aluminium interior the unit fits seamlessly into any back bar, even while using its integrated LED lighting!

Coming as standard with 2 shelves per self closing double glazed door this unit is an all-round perfect choice for the budget minded buyer!



Features

- Black laminated exterior
- Stippled aluminium interior
- Self closing door(s)
- 2 Adjustable shelves supplied as standard
- Door lock fitted per door
- Internal LED illumination with on/off switch
- Adjustable feet
- Replaceable door gasket



KBC2SL

DOORS	2
GROSS CAPACITY (BOTTLES)	218L (202)
SHELVES SUPPLIED	4
REFRIGERANT	R600a
TEMPERATURE RANGE	+4°C / +10°C
DIMENSIONS (mm)	H900 x W900 x D520
ENERGY RATING	F
POWER USAGE	210W
KWH/ANNUM	1011
POWER	13amp
WEIGHT (kg)	73

RRP £696

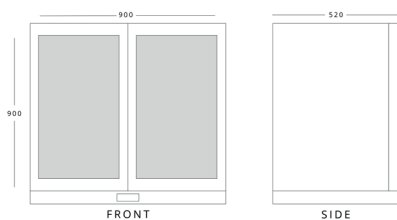

KOLDBOX KBC2SL
H 900mm W 900mm D 520mm



KBC3SL

DOORS	3
GROSS CAPACITY (BOTTLES)	338L (338)
SHELVES SUPPLIED	3
REFRIGERANT	R600a
TEMPERATURE RANGE	+4°C / +10°C
DIMENSIONS (mm)	H900 x W1350 x D520
ENERGY RATING	F
POWER USAGE	270W
KWH/ANNUM	1260
POWER	13amp
WEIGHT (kg)	89

RRP £946

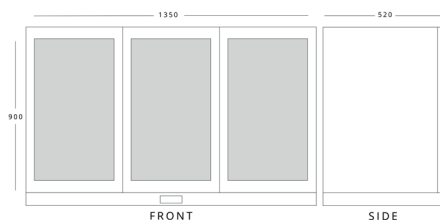

KOLDBOX KBC3SL
H 900mm W 1350mm D 520mm

STORAGE REFRIGERATION EQUIPMENT

Whether you're looking for high capacity storage or flexible preparation units we have crafted a small selection of perfectly built storage options that suit even the smallest of budgets.

Encompassing all the standard quality of life features you would expect from a modern refrigerated storage unit our range is constructed as standard with 201 stainless steel to give you the same great finish for a fraction of the cost.

Now available at a **NEW** discounted price and with **2 years warranty** as standard you'll struggle to justify any other choice.





NEW STAINLESS STEEL UNDER COUNTER REFRIGERATION

Description

A budget beating addition to the KoldBox range new for 2023 the KXR200 & KXF200 are the perfect under counter unit for every situation. Coming with a sleek stainless steel exterior and white ABS interior paired with 2 adjustable shelves and 2 fixed shelves respective as standard.

With features such as a reversible door, replaceable door gaskets and rollers fitted to allow for easier manoeuvrability the KXF/R under counter range is sure to make a splash this year!



Features

Stainless Steel exterior

White ABS interior

Lock fitted as standard

Replaceable door gasket

Reversible door

Rollers fitted to the rear, adjustable feet to the front

2 shelves as standard



KXR200

GROSS CAPACITY	113L
SHELVES SUPPLIED	2
REFRIGERANT	R600a
TEMPERATURE RANGE	+2°C / +10°C
DIMENSIONS (mm)	H830 x W595 x D640
ENERGY RATING	B
POWER USAGE	90W
KWH/ANNUM	237
POWER	13amp
WEIGHT (kg)	41

RRP £598

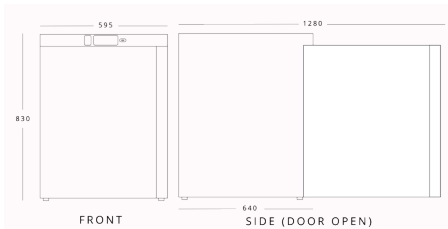

KOLDBOX KXR200
H 830mm W 595mm D 640mm



KXF200

GROSS CAPACITY	113L
SHELVES SUPPLIED	2
REFRIGERANT	R600a
TEMPERATURE RANGE	-10°C / -20°C
DIMENSIONS (mm)	H830 x W595 x D640
ENERGY RATING	B
POWER USAGE	91W
KWH/ANNUM	402
POWER	13amp
WEIGHT (kg)	43

RRP £628

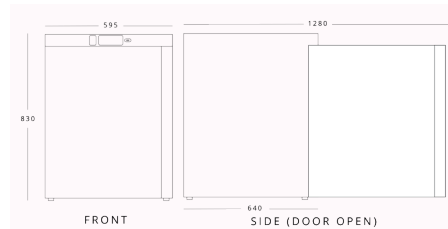

KOLDBOX KXF200
H 830mm W 595mm D 640mm

KXR600



SINGLE DOOR VENTILATED UPRIGHT STAINLESS STEEL GASTRONORM REFRIGERATION

Description

The KXR/KXF units feature a 201 stainless steel exterior and interior. Rounded corners allow the units to be easily cleaned and maintained only helped by the ability to easily move them around thanks to the heavy duty castors that are fitted as standard on all configurations.

Self-closing doors with dwell position, 3 adjustable shelves per door, 60mm thick insulation, led lighting and more all contribute to this amazing value products success.



Features

201 stainless steel exterior & interior

Internal corners rounded to aid cleaning

3 adjustable GN2/1 shelves supplied per door, shelf size 535 x 650 mm

LED lighting

Lock fitted as standard

Heavy duty castors as standard

Suitable for fresh meat storage

Self closing door(s) with dwell position



KXR600



KXF600

GROSS CAPACITY	600L
SHELVES SUPPLIED	3
REFRIGERANT	R290
TEMPERATURE RANGE	-2°C / +8°C
DIMENSIONS (mm)	H2000 x W680 x D840
ENERGY RATING	D
POWER USAGE	195W
KWH/ANNUM	815
POWER	13amp
WEIGHT (kg)	125

RRP £1235

GROSS CAPACITY	600L
SHELVES SUPPLIED	3
REFRIGERANT	R290
TEMPERATURE RANGE	-18°C / -22°C
DIMENSIONS (mm)	H2000 x W680 x D840
ENERGY RATING	E
POWER USAGE	450W
KWH/ANNUM	2826
POWER	13amp
WEIGHT (kg)	132

RRP £1393

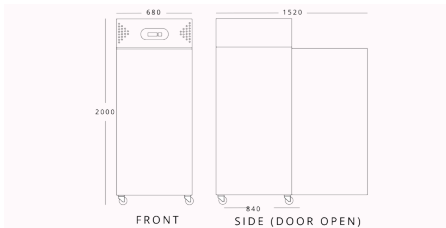

KOLDBOX KXR600
H 2000mm W 680mm D 840mm

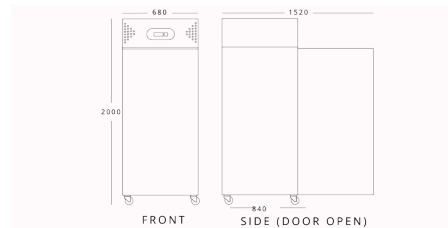

KOLDBOX KXF600
H 2000mm W 680mm D 840mm



DOUBLE DOOR VENTILATED UPRIGHT STAINLESS STEEL GASTRONORM REFRIGERATION

Description

The KXR/KXF units feature a 201 stainless steel exterior and interior. Rounded corners allow the units to be easily cleaned and maintained only helped by the ability to easily move them around thanks to the heavy duty castors that are fitted as standard on all configurations.

Self-closing doors with dwell position, 3 adjustable shelves per door, 60mm thick insulation, led lighting and more all contribute to this amazing value products success.



Features

201 stainless steel exterior & interior

Internal corners rounded to aid cleaning

3 adjustable GN2/1 shelves supplied per door, shelf size 535 x 650 mm

LED lighting

Lock fitted as standard

Heavy duty castors as standard

Suitable for fresh meat storage

Self closing door(s) with dwell position



KXR1200

GROSS CAPACITY	1200L
SHELVES SUPPLIED	6
REFRIGERANT	R290
TEMPERATURE RANGE	-2°C / +8°C
DIMENSIONS (mm)	H2000 x W1340 x D840
ENERGY RATING	D
POWER USAGE	380W
KWH/ANNUM	1382
POWER	13amp
WEIGHT (kg)	213

RRP £1574

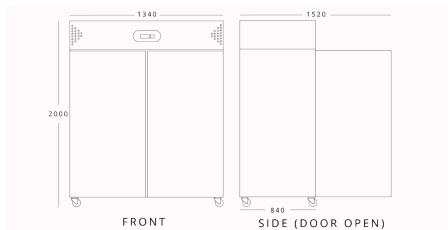

KOLDBOX KXR1200
H 2000mm W 1340mm D 840mm



KXF1200

GROSS CAPACITY	1200L
SHELVES SUPPLIED	6
REFRIGERANT	R290
TEMPERATURE RANGE	-18°C / -22°C
DIMENSIONS (mm)	H2000 x W1340 x D840
ENERGY RATING	E
POWER USAGE	700W
KWH/ANNUM	4317
POWER	13amp
WEIGHT (kg)	221

RRP £1686

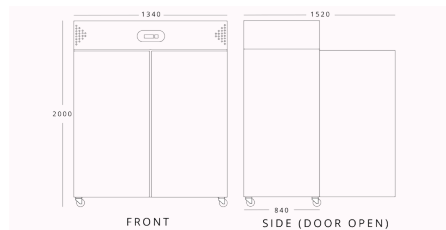

KOLDBOX KXF1200
H 2000mm W 1340mm D 840mm

KXCC2



COMPACT SOLID DOOR STAINLESS STEEL GASTRONORM COUNTER

Description

Featuring 201 stainless steel exterior and interior, the KoldBox compact storage counters are a great low budget option for any kitchen. This range was designed with convenience and efficiency in mind and thanks to its rounded corners and removable condenser filter and door gaskets it achieves just that!

The units include one adjustable shelf per door, 35mm insulation, dixell digital controller and the option to be mounted to castors.

Features

- 201 stainless steel exterior & interior
- Internal corners rounded to aid cleaning
- 1 x adjustable GN1/1 shelf per door
- Replaceable door gasket
- 35mm insulation
- 4 feet
- Removable condenser filter for cleaning





KXCC2

GROSS CAPACITY	240L
SHELVES SUPPLIED	2
REFRIGERANT	R600a
TEMPERATURE RANGE	+2°C / +8°C
DIMENSIONS (mm)	H876 x W903 x D700
ENERGY RATING	D
POWER USAGE	170W
KWH/ANNUM	1205
POWER	13amp
WEIGHT (kg)	86

RRP £790

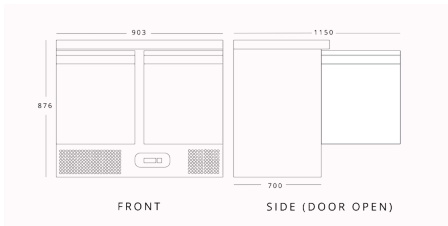

KOLDBOX KXCC2
H 876mm W 903mm D 700mm



KXCC3

GROSS CAPACITY	368L
SHELVES SUPPLIED	3
REFRIGERANT	R290
TEMPERATURE RANGE	+2°C / +8°C
DIMENSIONS (mm)	H876 x W1368 x D700
ENERGY RATING	E
POWER USAGE	240W
KWH/ANNUM	1825
POWER	13amp
WEIGHT (kg)	126

RRP £1147

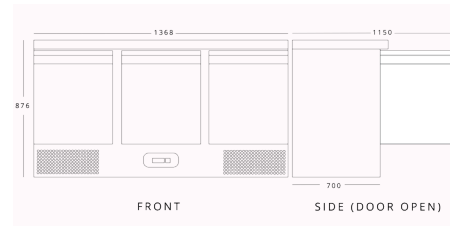

KOLDBOX KXCC3
H 876mm W 1368mm D 700mm

KXCC2-SAL



COMPACT SOLID DOOR STAINLESS STEEL PREP COUNTER

Description

The perfect budget beating prep counter solution with fantastic features such as a 201 grade stainless steel construction and rounded internal corners for ease of cleaning. Fan assisted cooling can be operated using the integrated digital dixel controller.

Designed keeping convenience in mind, the raised collar can easily fit GN1/6 containers with maximum depth of 150mm and the unit comes as standard with 1 shelf per door for internal storage.



Features

- 201 stainless Steel exterior & interior
- Internal corners rounded to aid cleaning
- 1 x adjustable GN1/1 shelf per door
- Raised collar accepts GN1/6 containers - Max depth 150mm (not supplied)
- Replaceable door gasket
- 35mm insulation
- 4 feet
- Removable condenser filter for cleaning



KXCC2-SAL

GROSS CAPACITY	240L
SHELVES SUPPLIED	2
CONTAINER CAPACITY	5 x GN1/6
REFRIGERANT	R600a
TEMPERATURE RANGE	+2°C / +8°C
DIMENSIONS (mm)	H961 x W903 x D700
POWER USAGE	170W
POWER	13amp
WEIGHT (kg)	87

RRP £996

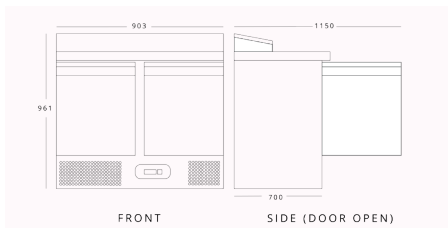

KOLDBOX KXCC2-SAL
H 961mm W 903mm D 700mm



KXCC3-SAL

GROSS CAPACITY	392L
SHELVES SUPPLIED	3
CONTAINER CAPACITY	8 x GN1/6
REFRIGERANT	R290
TEMPERATURE RANGE	+2°C / +8°C
DIMENSIONS (mm)	H961 x W1368 x D700
POWER USAGE	240W
POWER	13amp
WEIGHT (kg)	141

RRP £1295

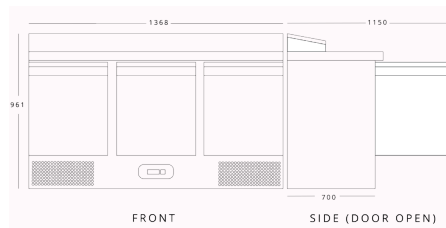

KOLDBOX KXCC3-SAL
H 961mm W 1368mm D 700mm

KXCC2-PREP



COMPACT SOLID DOOR STAINLESS STEEL SALADETTE

Description

The perfect budget beating compact saladette from KoldBox promises great things for an incredibly low price! With a full GN well cover hinged for easy access plus a polypropylene cutting board installed as standard.

Make the most of your refrigerated storage space thanks to the included shelf per door plus benefit from key features such as internal rounded corners, adjustable feet, replaceable door gaskets, 35mm insulation and removable condenser filter.



Features

- 201 stainless steel exterior & interior
- Internal corners rounded to aid cleaning
- 1 x adjustable GN1/1 shelf per door
- GN sized well accepts containers - Max depth 150 mm
- Hinged lid over GN well
- 135mm deep polypropylene cutting board
- 35mm insulation
- Removable condenser filter for cleaning



KXCC2-PREP

GROSS CAPACITY	240L
SHELVES SUPPLIED	2
CONTAINER CAPACITY	2 x GN1/1 + 3 x GN1/6
REFRIGERANT	R600a
TEMPERATURE RANGE	+2°C / +8°C
DIMENSIONS (mm)	H877 x W903 x D700
POWER USAGE	170W
POWER	13amp
WEIGHT (kg)	80

RRP £790

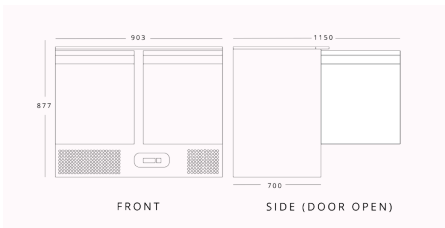

KOLDBOX KXCC2-PREP
H 877mm W 903mm D 700mm



KXCC3-PREP

GROSS CAPACITY	368L
SHELVES SUPPLIED	3
CONTAINER CAPACITY	4 x GN1/1
REFRIGERANT	R290
TEMPERATURE RANGE	+2°C / +8°C
DIMENSIONS (mm)	H877 x W1368 x D700
POWER USAGE	240W
POWER	13amp
WEIGHT (kg)	130

RRP £1147

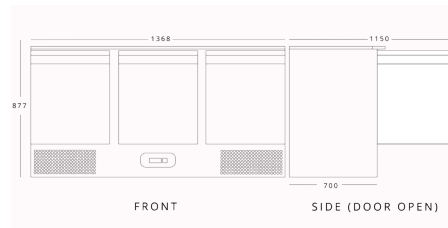

KOLDBOX KXCC3-PREP
H 877mm W 1368mm D 700mm

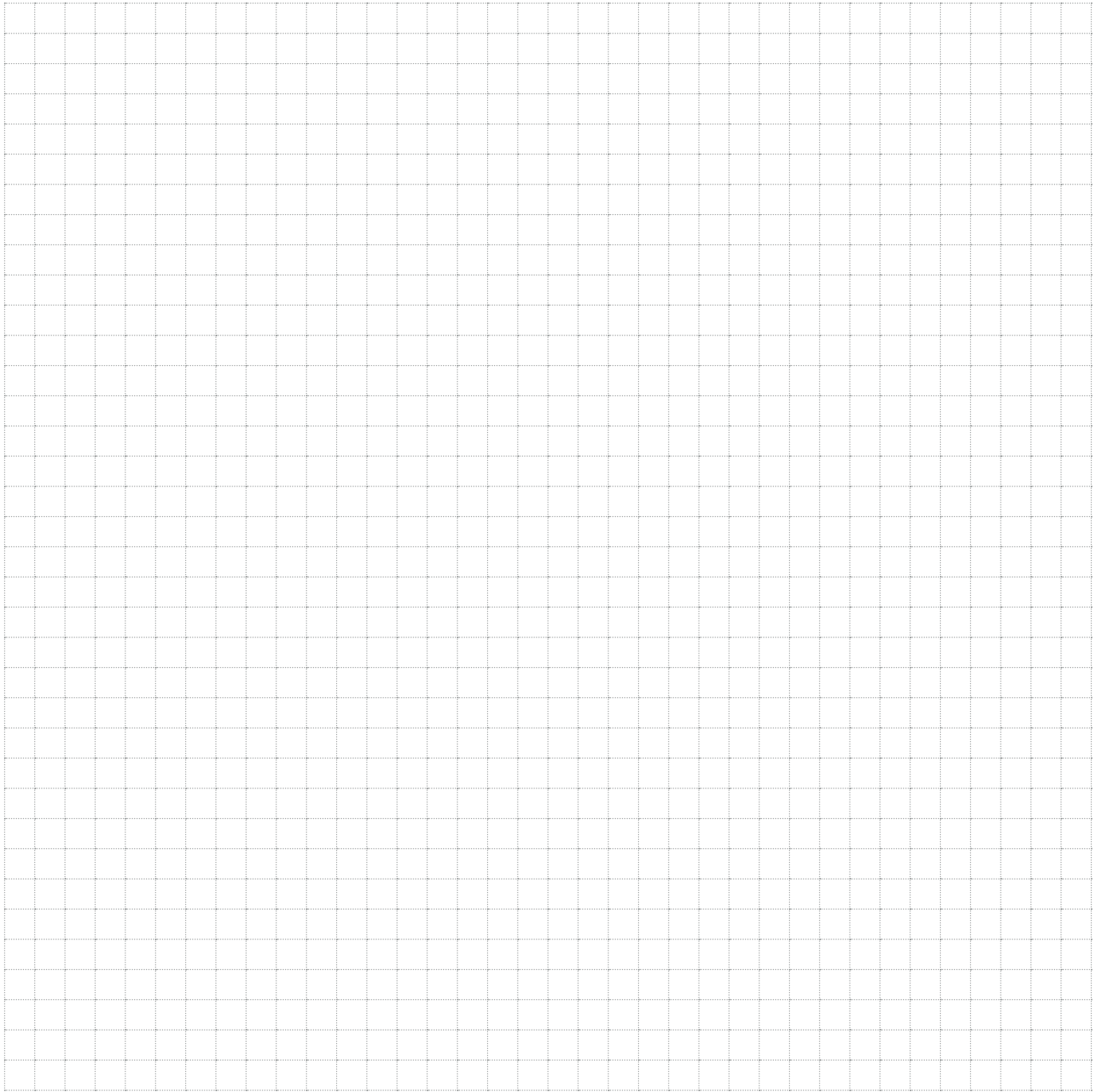

Pentland Wholesale Limited

Blizzard House

Unit 17, Walker Industrial Estate
Walker Road, Blackburn, Lancashire
BB1 2QE

T: 01254 614444

F: 01254 614477

E: sales@pentlandwholesale.co.uk

W: www.pentlandwholesale.co.uk

EXCLUSIVELY AVAILABLE FROM

